



SPECIFICATIONS

2017.12.18



LED projector for High-temperature +100°C PH-T series			
Model	PH-T24-HT100	PH-T48-HT100	PH-T72-HT100
Power	18W	35W	50W
Lumens	1440lm	2880lm	4320lm
Size	286×177×204mm	317×286×267mm	457×286×267mm
Weight	4.0kg	7.0kg	9.0kg
Model	PH-T96-HT100	PH-T120-HT100	
Power	66W	80W	
Lumens	5760lm	6900lm	
Size	597×286×267mm	737×286×267mm	
Weight	11.0kg	13.0kg	

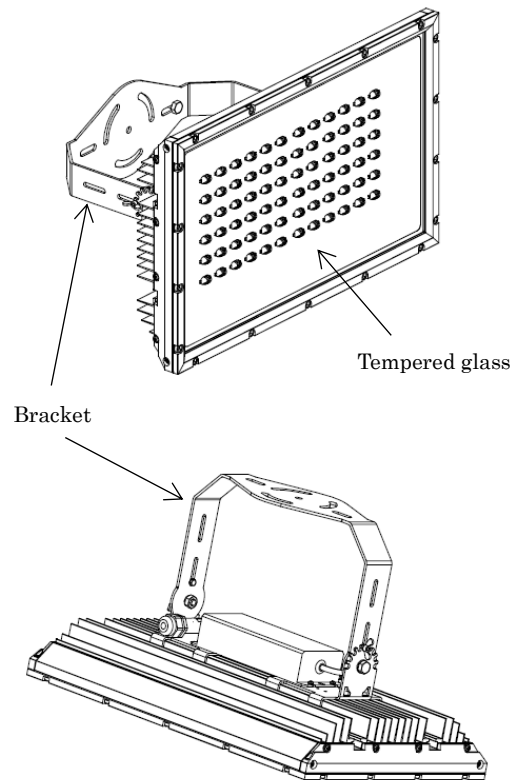

Common Specifications	
Input Voltage	AC100~240V 50/60Hz
Color temp.	6000K (Cool white)
CRI	70+
LED	CREE
Lifetime	20000 hours
Cone Angle	60° × 90°
	60° × 135°
	85° × 150°
Material	Lamp body: Aluminun alloy
	Cover: Tempred glass
	Bracket: SUS304
Bpdy color	Silver
Operating ambient temperature	-40°C ~ +100°C (Lamp)
	-40°C ~ +60°C (LED driver)
IP Code	IP67
LED driver	Meanwell LED driver*
Guarantee	1 year



*LED driver should be installed in normal ambient temperature away from the luminaire.
The cable length between the luminaire and the driver should be within 25m.

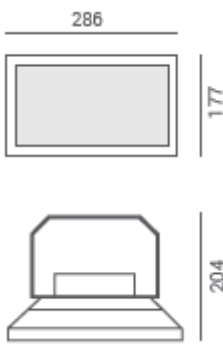
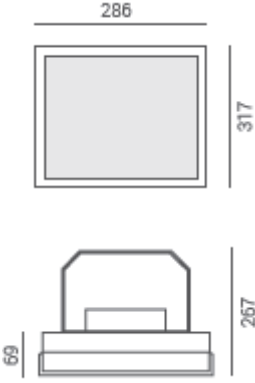
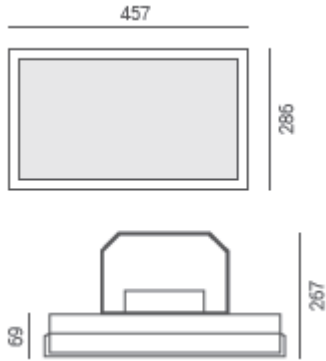

PH-T24-HT100	PH-T48-HT100	PH-T72-HT100
		
		

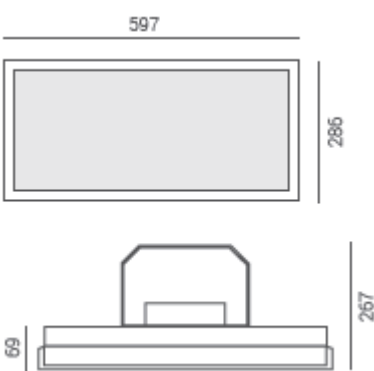
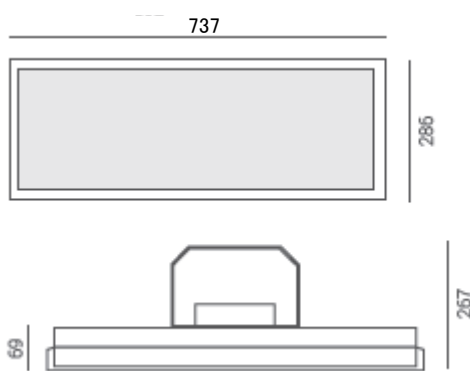
PH-T96-HT100	PH-T120-HT100
	
	



■ Installation at high ambient temperature environment

External LED driver is attached to PH-T series.

LED driver should be installed in normal ambient temperature away from the luminaire.

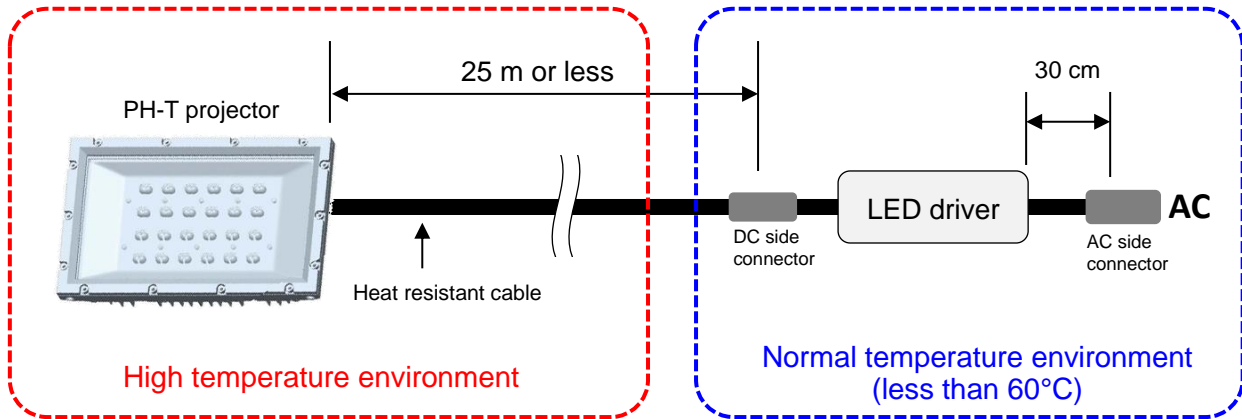

■ Cone angle

60°x90°

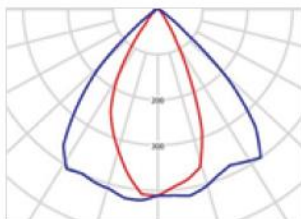

60°x135°

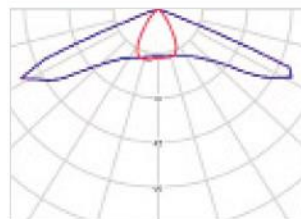

85°x150°

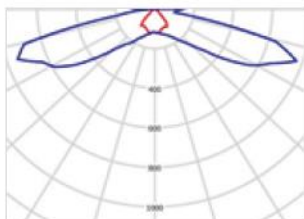



■ How to Install

PH-T24

PH-T48 / PH-T72 / PH-T96 / PH-T120

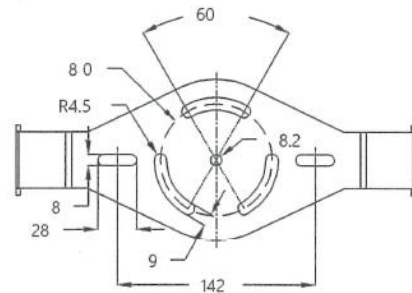
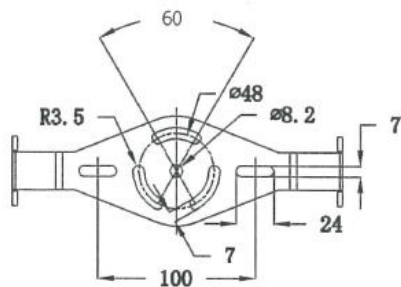
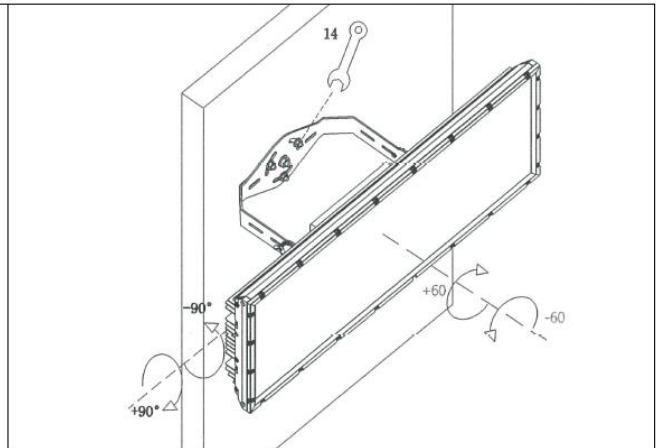
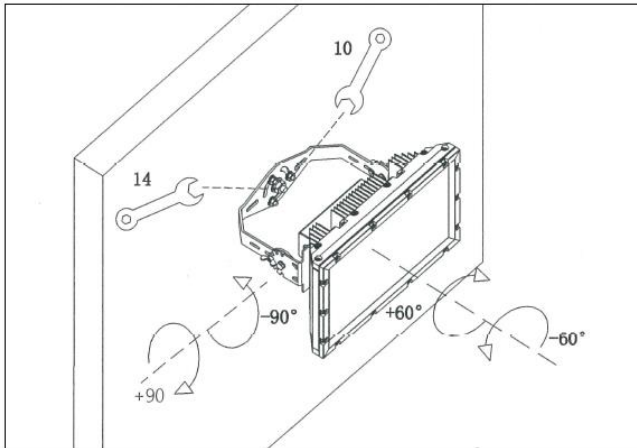

■ Connector (AC side)

■ Holder Options

